

Reed Relay Selection Guide

High-voltage, SIP, DIL, DIN-rail module and contactor families — generated from validated datasheet records and model-level assets.

268
MODELS

8
FAMILIES

1–20 kV
BREAKDOWN



Fast selection route

- 1

Define isolation & switching voltage
Use breakdown voltage as insulation margin; verify switching voltage from the exact datasheet.
- 2

Choose package & wiring style
PCB compact: SIP / DIL / HVR. Cabinet wiring: HRM DIN rail. High-current load: ESM.
- 3

Select contact form and coil
Match 1A/1B/1C/2A/2C/4A/6A/12A/20A and 5/12/24 VDC coil requirements.
- 4

Confirm load rating and pinout
Check W/A rating, pin/package code, shield/diode options, and PDF before RFQ.

Choose by Product Family

Start from the application and mechanical integration style, then narrow by exact voltage, contact form, coil and pinout.

HVR163 models

Breakdown

Switching

Contact

Rating

Package

Examples

1–20 kV

7.5 kV, 10 kV

1 Form A, 2 Form A, 1 Form B

50 W, 100 W, 200 W

PCB HV package, multiple pin codes

HVR1A05, HVR1A12, HVR1A24

PCB high-voltage reed relay families for compact HV switching and isolation.

HRM49 models

Breakdown

Switching

Contact

Rating

Package

Examples

1–15 kV

7 kV, 1 kV

6 Form A, 2 Form A, 12 Form A

10 W, 100 W, 50 W

DIN rail, screw terminals

HRM05-1A10, HRM05-1A15, HRM05-2A10

DIN-rail high-voltage relay modules for cabinet wiring and service access.

SIP-HV25 models

Breakdown

Switching

Contact

Rating

Package

Examples

3–4 kV

1.5 kV

1 Form A

100 W

SIP through-hole, shield/diode options

SIP-HV1A05, SIP-HV1A12, SIP-HV1A24

SIP high-voltage reed relays for compact instrument and tester boards.

SIP-HC3 models

Breakdown

Switching

Contact

Rating

Package

Examples

4 kV

1.5 kV

1 Form A

150 W

SIP through-hole, magnetic shield

SIP-HC1A05S, SIP-HC1A12S, SIP-HC1A24S

High-current SIP reed relay variants when contact power margin is critical.

SIP12 models

Breakdown

Switching

Contact

Rating

Package

Examples

1.4 kV

1.4 kV

1 Form A, 1 Form B

10 W, 5 W

SIP through-hole

SIP-1A05, SIP-1A12, SIP-1A24

Signal-level SIP reed relays for dense PCB switching.

DIL12 models

Breakdown

Switching

Contact

Rating

Package

Examples

1.4–4 kV

1.4 kV, 4 kV

2 Form A, 1 Form C, 2 Form C

10 W, 5 W

DIL through-hole

DIL-1C05, DIL-1C12, DIL-1C24

Dual-in-line PCB relays for classic DPST/SPDT/DPDT signal switching.

4003 models

Breakdown

Switching

Contact

Rating

Package

Examples

5–10 kV

7.5 kV, 2.5 kV

2 Form C

50 W

PCB relay pinout

400-133, 400-572, 400-959

Legacy / special PCB high-voltage relay models with 2 Form C contacts.

ESM1 models

Breakdown

Switching

Contact

Rating

Package

Examples

4 kV

1.5 kV

1 Form A

150 A

Contactor terminals

ESM-150

High-current DC contactor style product for load isolation, not a small signal reed relay.

Breakdown Voltage Selection Map

Model distribution by nominal breakdown voltage. Use this as the first filter, then verify switching voltage, contact rating and package code on the product datasheet.

Models by breakdown voltage

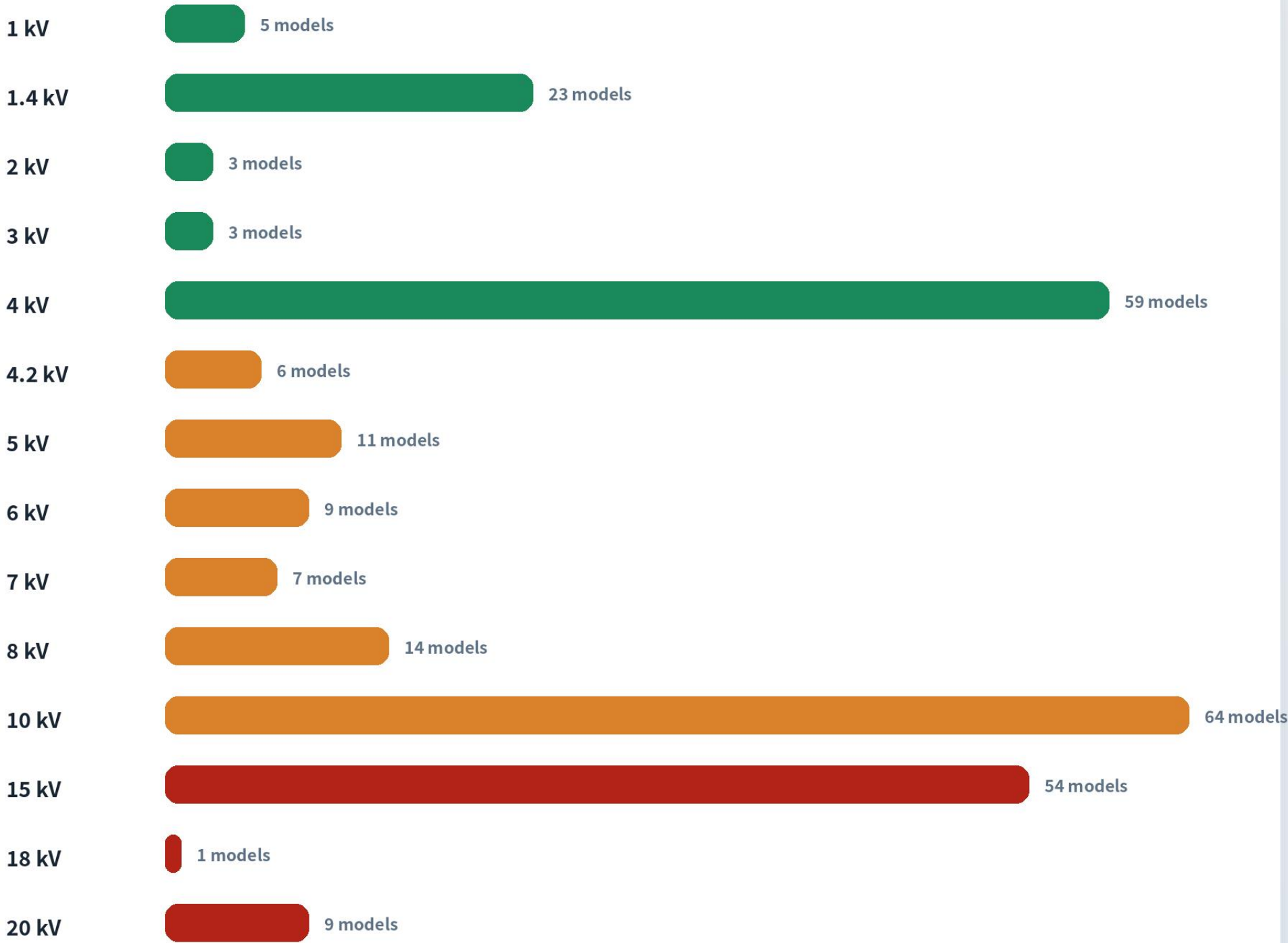

Practical voltage bands

≤1.4 kV

Signal / compact PCB switching

SIP, DIL

3–4.2 kV

Compact HV boards / higher isolation

SIP-HV, SIP-HC, HVR

5–10 kV

General high-voltage switching

HVR, HRM, 400

15–20 kV

Highest isolation margin

HVR, HRM

HVR High-Voltage PCB Relay Selector

HVR is the largest family in the catalog: 163 independent SKUs with separate datasheets and package-code variants.

163

HVR models

1–20 kV

breakdown

50–200 W

contact rating

31+

package code styles

Typical HVR ordering code anatomy

HVR12 - 1A10 - 06 - P1

HVRSeries

12Coil: 12 VDC

1AContact form

10Breakdown grade: 10 kV

06Pin/package code

P1Variant suffix

Filter HVR by engineering requirement

Coil voltage

24 VDC72

12 VDC65

5 VDC26

Contact form

1 Form A96

2 Form A26

1 Form B25

1 Form C6

4 Form A6

2 Form C4

Breakdown

10 kV48

15 kV40

4 kV24

8 kV11

20 kV9

5 kV7

Rating

50 W98

100 W53

200 W12

Common HVR package / pin-code starting points

02

HVR PCB package

24 models

150

HVR PCB package

21 models

BASE

HVR PCB package

15 models

06

HVR PCB package

12 models

03

HVR PCB package

9 models

05

HVR PCB package

8 models

01

HVR PCB package

8 models

04

HVR PCB package

6 models

06, HC

HVR PCB package

5 models

211

HVR PCB package

4 models

Package & Pinout Style Guide

Use pinout style as the second filter after electrical requirements. Each final SKU still requires checking its exact product datasheet.

HVR code 06 / PCB HV



Representative drawing extracted from generated selection-manual assets.

HVR code 150 / PCB HV



Representative drawing extracted from generated selection-manual assets.

HVR SMD pads

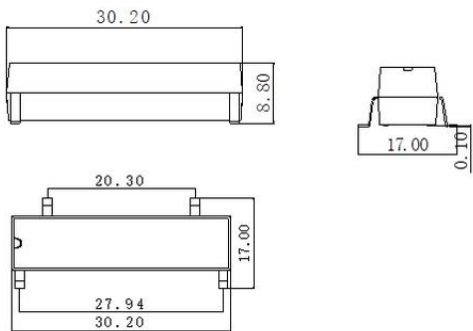

Representative drawing extracted from generated selection-manual assets.

HRM DIN rail module

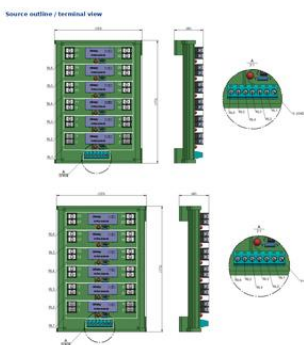

Representative drawing extracted from generated selection-manual assets.

SIP-HV diode option



Representative drawing extracted from generated selection-manual assets.

SIP signal relay

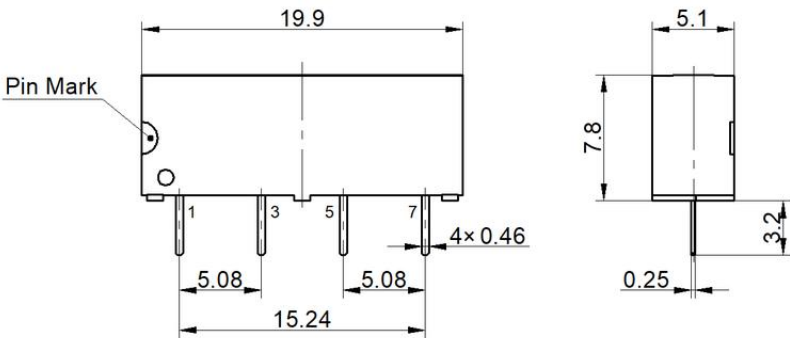

Representative drawing extracted from generated selection-manual assets.

DIL through-hole

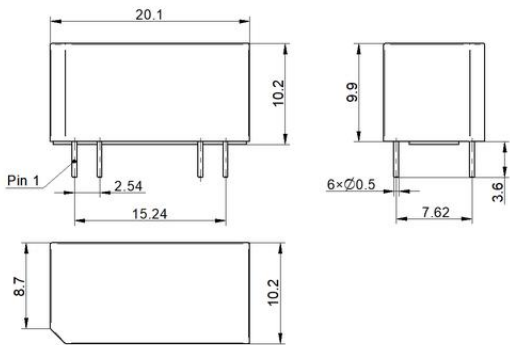

Representative drawing extracted from generated selection-manual assets.

400 series PCB

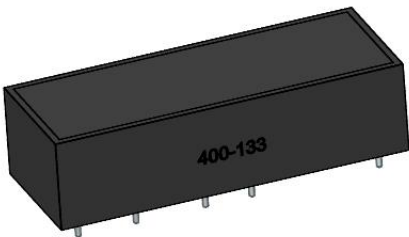

Representative drawing extracted from generated selection-manual assets.

Engineering RFQ Checklist

A selection guide reduces the model list; the final quote should still include load, environment and package constraints.

Information to include in a quote request

- 1

Target model or family
Example: HVR12-1A10-06-P1, HVR 10 kV PCB relay, or HRM DIN-rail module.
- 2

Electrical requirement
Switching voltage/current, load type, carry current, isolation/breakdown target and duty cycle.
- 3

Contact & coil
Contact form, coil voltage, diode/shield requirement, operate/release timing if critical.
- 4

Mechanical integration
PCB footprint/pin code, DIN rail space, terminal wiring, creepage/clearance constraints.
- 5

Quantity and compliance context
Sample quantity, annual volume, application area and any customer test standards.

Start here: model-family routing

Need highest PCB isolation / compact HV package	HVR	Filter by kV grade, contact form, coil and pin/package code.
Need field wiring, cabinet installation or serviceable module	HRM	DIN-rail screw-terminal modules, many multi-pole Form A/B/C variants.
Need compact 1 Form A high-voltage PCB relay	SIP-HV / SIP-HC	Use SIP-HV for HV board layouts; SIP-HC when rating margin is the driver.
Need dense signal-level PCB switching	SIP / DIL	Use SIP for narrow single-in-line layout; DIL for DPST/SPDT/DPDT footprint needs.
Need high-current DC load switching	ESM	Treat as contactor-class product; confirm current, coil and load profile.

Website integration note

All model pages should link the same SKU to its individual PDF datasheet and RFQ prefill URL. Avoid fuzzy SKU matching for suffix variants such as -P1, -P2, -YP, -HC.