

HVR12-1A15-156

High Voltage Reed Relay

PRODUCT VISUAL

SOURCE IMAGE NOT AVAILABLE

fallback vector render no exact product photo or embedded product render in pdf

KEY RATINGS

COIL VOLTAGE
12 VDC

CONTACT FORM
1 Form A

SWITCH VOLTAGE
10 kVDC

CONTACT RATING
50 W

OVERVIEW

- High voltage reed relay
- Breakdown up to 15 kVDC
- Custom design available
- Low contact resistance
- Excellent lifetime characteristics

COIL DATA

Nominal Coil Voltage	12 VDC
Nominal Current	60 mA
Coil Resistance	200±10% Ω
Max Pull-in Voltage	9 VDC
Min Drop-out Voltage	1 VDC

CONTACT RATINGS

Contact Form	1 Form A
Max Contact Rating	50 W
Max Switch Voltage	10 kVDC
Max Switch Current	3.0 A
Max Carrying Current	5.0 A
Min Breakdown Voltage	15 kVDC
Max Contact Resistance	150 mΩ
Life Expectancy	5×10⁷ ops @500V 100mA

ELECTRICAL CHARACTERISTICS

Dielectric Open / Coil	15 / 15 kVDC
Insulation Open / Coil	1×10¹² Ω each
Operate Time incl. Bounce	3.0 ms
Reset Time	1.5 ms
Capacitance	1.0 pF across open switch

ENVIRONMENTAL / OPTIONS

Vibration	20 G, 10-2KHz 1.5mm
Shock	50 G, 11ms half-sine
Operating Temperature	-20°C to +70°C
Storage Temperature	-35°C to +105°C
Soldering Temperature	260°C, 5 sec max
Washability	Fully sealed

MECHANICAL OUTLINE / DIMENSIONS

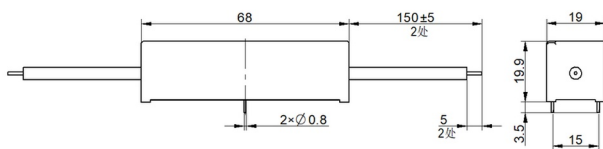

CIRCUIT / MARKING / TERMINAL VIEW



ORDERING & SOURCE TRACEABILITY

HVR12-1A15-156 — HVR, 12 = 12 VDC, 1A = 1 Form A, 15 = 15 kVDC, Pin Out = 156, Special = Nil

Source: HVR12-1A15-156.pdf

Technical values are preserved from source PDFs / generated metadata. Original outline and circuit figures are reused where available; do not treat artwork proportions as standalone dimensional authority.